



AQUACULTURE - LICENSING UNDER
FISHERIES (AMENDMENT) ACT 1997 as amended
and
FORESHORE ACT 1933 as amended

*Application Form for an Aquaculture and Foreshore Licence for
a single specific site.*
*If a Licence is required for more than one site a separate
application form must be completed for each site.*

Important Note

Section 4 of the Fisheries and Foreshore (Amendment) Act, 1998 (No. 54 of 1998) prohibits any person making an application for an Aquaculture Licence from commencing aquaculture operations until duly licensed under the Fisheries (Amendment) Act, 1997 (No. 23 of 1997), and provides that a breach of that prohibition will cause the application to fail.

A copy of an Environmental Impact Statement should be enclosed, if required, with all new, review and renewal applications. See Guidance Notes Section 3.

**Aquaculture & Foreshore Management Division,
Department of Agriculture, Food and the Marine,
National Seafood Centre,
Clonakilty, Co. Cork
Telephone: (023) 8859500
Fax: (023) 8821782**

AQUACULTURE AND FORESHORE LICENCE APPLICATION FORM, for purposes of FISHERIES (AMENDMENT) ACT, 1997 and FORESHORE ACT, 1933

NB: The accompanying Guidance Notes should be read before completing this form.

Note: Details provided in Parts 1 and 2 will be made available for public inspection. Details provided in Parts 3 and 4 and any other information supplied will not be released except as may be required by law, including the Freedom of Information Act 1997 as amended.

USE BLOCK CAPITALS IN BLACK INK PLEASE

For Office Use

Application Ref. No. T6/368.

Date of Receipt (Dept. Stamp):

Type of Applicant (tick one)	
Sole Trader	<input checked="" type="checkbox"/>
Partnership	<input type="checkbox"/>
Company	<input type="checkbox"/>
Co-Operative	<input type="checkbox"/>
Other	Please specify- <input type="checkbox"/>

PART 1: PRELIMINARY DETAILS

Applicant's Name(s)	<u>Martin J. Riordan</u>
1.	
Address:	<u>Tullig Beg Kilorglin Co. Kerry</u>
2.	
Address:	
3.	
Address:	
4.	
Address:	

2.2 MARINE-BASED SHELLFISH AQUACULTURE

When filling out this section refer also to 2.2A and Guidance Note 3.3 for information on Conditions and Documents required with this application type

Proposed Site Location

- (i) Bay: Castlemaine Harbour
- (ii) County: Kerry
- (iii) OS Map No: K446 and K456
- (iv) Co-ordinates of Site: (please specify coordinate reference system used e.g. Irish Grid (IG) or Irish Transverse Mercator (ITM) or Latitude/Longitude [in which case specify whether ETRS89 or WG84 etc.]
Irish grid: (72 696 98 294)
(72 896 98 294) (72 896 98 074)
(72 696 98 074) (72 567 98 110)
- (v) Size of Site (hectares): 5.82

(vi) Species (common and scientific name) and whether native or non-native species: (see Guidance Notes 3.3.1)

Crassostrea gigas - Pacific Oysters - Non native

(vii) Whether production will be sub-tidal or inter-tidal?

inter-tidal

(viii) Please supply details of (a) source of seed e.g. wild hatchery and location and (b) means of collection and introduction to culture.

(A) France - Noisain seed (A) shellfish

growers of Ireland pick up in France and deliver to Ireland

NB Importation of seed into the State or movement of seed within the State requires notification to the Marine Institute as per the Fish Health Authorisation Regulations - See Guidance Notes Section 6

(ix) Method of culture (rope, trestles - intensive; bottom - extensive; other) Trestles - intensive

(x) Proposed number of lines/ropes/trestles as per site layout drawing

as per site layout drawing and depending on ground conditions

(xi) Proposed Production Tonnage:

Year 1	35	Year 2	35	Year 3	35	Year 4	35	Year 5	35
--------	----	--------	----	--------	----	--------	----	--------	----

(xii) (a) Please outline the reasons for site selection:

mostly good solid ground for holding trestles and working on

Contact in case of enquiries (if different from above)	
Contact Name	
Organisation Name (if applicable)	
Address	

PART 1: PRELIMINARY DETAILS

TYPE OF APPLICATION – please indicate relevant type of application This Application Form is valid for each type of application - <i>See Guidance Note 3.1</i>	
(i) Aquaculture Licence	<input checked="" type="checkbox"/>
(ii) Trial Licence	<input type="checkbox"/>
(iii) Foreshore Licence, if Marine Based	<input type="checkbox"/>
(iv) Review of Aquaculture Licence	<input type="checkbox"/>
(v) Renewal of Aquaculture Licence	<input type="checkbox"/>

TYPE OF AQUACULTURE

See Guidance Note 3.2

Indicate the relevant type of application with a tick.

(i) **MARINE-BASED**

- | | | |
|------------------------------------------|-------------------------------------|--------------------------|
| Finfish | <input type="checkbox"/> | Go to Parts 2.1 and 2.1A |
| Shellfish <i>Subtidal</i> | <input type="checkbox"/> | Go to Parts 2.2 and 2.2A |
| <i>Intertidal</i> | <input checked="" type="checkbox"/> | Go to Parts 2.2 and 2.2A |
| Seaweed/Aquatic Plants/Aquatic Fish Food | <input type="checkbox"/> | Go to Parts 2.3 and 2.3A |

(ii) **LAND-BASED**

- | | | | | |
|----------------|--------------------------|-------------------|--------------------------|--------------------------|
| Finfish | <input type="checkbox"/> | Shellfish | <input type="checkbox"/> | Go to Parts 2.4 and 2.4A |
| Aquatic Plants | <input type="checkbox"/> | Aquatic Fish Food | <input type="checkbox"/> | Go to Parts 2.4 and 2.4A |

(iii) **TRIAL LICENCE**

- | | |
|--------------------------|---------------------------------------------------|
| <input type="checkbox"/> | Go to appropriate Parts as above and to Part 2.5. |
|--------------------------|---------------------------------------------------|

(b) If using trestles please outline the physical characteristics of the site which make it suitable for using trestles

SOLID GRAVEL GROUND

(xiii) Is it intended that the product is for direct human consumption or half grown? Please specify

HUMAN CONSUMPTION

(xiv) How will the visual impact issues of the flotation devices for the proposed application be addressed?

N/A

(xv) Is the site located in Designated Shellfish Waters Area? (Refer to Guidance Note 3.3.2)

Yes No

If yes give details.

If no outline the reasons why you believe the site suitable for the proposed aquaculture, notwithstanding its location outside Designated Shellfish Waters Area?

Castlemaine Harbour is a well developed mussel and oyster area

(xvi) Has the area been classified under Food Safety Legislation? (For Bivalve Molluscs) What is the current classification of the area for the proposed species applied for?

yes Class B

(xvii) Is the site located in/adjacent to a sensitive area e.g. SPA (Special Protection Area) or SAC (Special Area of Conservation) i.e. a Natura 2000 site? (Refer to Guidance Note 3.3.1- Natura 2000 sites)

yes

(xviii) Are there known sources of pollution in the vicinity e.g. sewage outfall? Yes / No
If yes please give full details.

NO

(xix) Methods used to harvest the shellfish and details of any subsequent processing of shellfish

BOAT TO SHORE TO TRANSPORT TO FRANCE

(xx) Describe any proposed purification facilities to be used: NONE

(xxi) What are the main predators of the species to be cultivated?

Birds and seals

(xxii) Describe the method(s) which will be used to control them

Nothing

See Part 2.2A for details of documentation to be included with this application type

2.2A DOCUMENTATION REQUIRED FOR MARINE-BASED SHELLFISH AQUACULTURE

(to be included separately with a Licence Application for a new site or for a renewal or review of an existing Licence)

1. An appropriate Ordnance Survey Map (recommendation is a map to the Scale of 1:10,000/1:10,560, i.e. equivalent to a six inch map). Note: The proposed access route to the site from the public road across tidal foreshore must also be shown on the map.
2. Scale drawing of the structures to be used and the layout of the farm.
The proposed site drawings must illustrate all site structures above and below the water including mooring blocks. (recommended scales normally 1:100 for structures and 1:200 for layout) (See Guidance Note 3.3.2)
3. The prescribed application fee (See Guidance Note Section 4)
4. If the applicant is a limited Company within the meaning of the Companies Act 1963. as amended, the Certificate of Incorporation and Memorandum and Articles of Association
5. If the applicant is a Co-operative, the Certificate of Incorporation and Rules of the Co-operative Society
6. Environmental Impact Statement (if required) in certain cases- See Guidance Notes Section 3.3.1
7. Alien Species dossier (where required) – See Guidance Notes Section 3.3.1

NOW COMPLETE PARTS 2.6, 3, 4 AND 5 PLEASE

**2.6 Employment, Qualifications, Experience, etc
TO BE FILLED IN BY ALL AQUACULTURE APPLICANTS**

(i) Please provide details of experience/qualifications of the applicant and any key personnel which are relevant to the aquaculture now proposed:

9 years experience growing oysters
 Certificate of Proficiency in Personal Survival Techniques on Board Ship
 Radio Operation Short Range

(ii) If a new application please provide details of projected employment creation during first four years of the proposed aquaculture project:

(iii) In the case of a renewal please provide current and future details:

one full time employment each year
 one / two part time employment as demand fits.

FULLTIME JOBS

Year 1:	1	Year 2:	1	Year 3:	1	Year 4:	1
---------	---	---------	---	---------	---	---------	---

PART TIME JOBS

Year 1:	—	Year 2:	1	Year 3:	2	Year 4:	2
---------	---	---------	---	---------	---	---------	---

PART 5: DECLARATION AND SIGNING

NB: Refer to Guidance Note Section 3.5 and Section 4 - Guidance on Declaration and Signing and Annual Aquaculture and Foreshore Licence Fees

If this is a renewal/review have you met all licence conditions of the existing aquaculture licence? If applicable, explain why you have not complied with all conditions:

I/We hereby declare the information provided in Parts 1, 2, 3 and 4 above to be true to the best of my/our knowledge. I/We enclose an application fee* of € Fee already paid under previous application

Signature(s) of Applicant(s):
(Please state capacity of persons signing on behalf of a Company/Co-op)

Martin Monahan T6368A

Date: 02-04-2014

NB All persons named on this licence application must sign and date this application form. Only the existing licence holder(s) can apply for the renewal/review of an Aquaculture Licence.

*Preferred method of payment is by cheque or bank draft. The fee should be made payable to the Department of Agriculture, Food and the Marine.

Refer to Guidance Note Section 4 - Guidance on Aquaculture and Foreshore Licence Fees

The application form should be forwarded, with the required documents and application fee, to:

**Aquaculture Licensing
Aquaculture & Foreshore Management Division
Department of Agriculture, Food and the Marine
National Seafood Centre
Clonakilty
Co. Cork**

1 NO. SITE AT CASTLEMAINE HARBOUR CO.KERRY

Co-ordinates & Area

Site T06/368A (5.82 Ha)

The area seaward of the high water mark and enclosed by a line drawn from Irish National Grid Reference point

072696, 098294 to Irish National Grid Reference point
072896, 098294 to Irish National Grid Reference point
072896, 098074 to Irish National Grid Reference point
072696, 098074 to Irish National Grid Reference point
072567, 098110 to the first mentioned point.



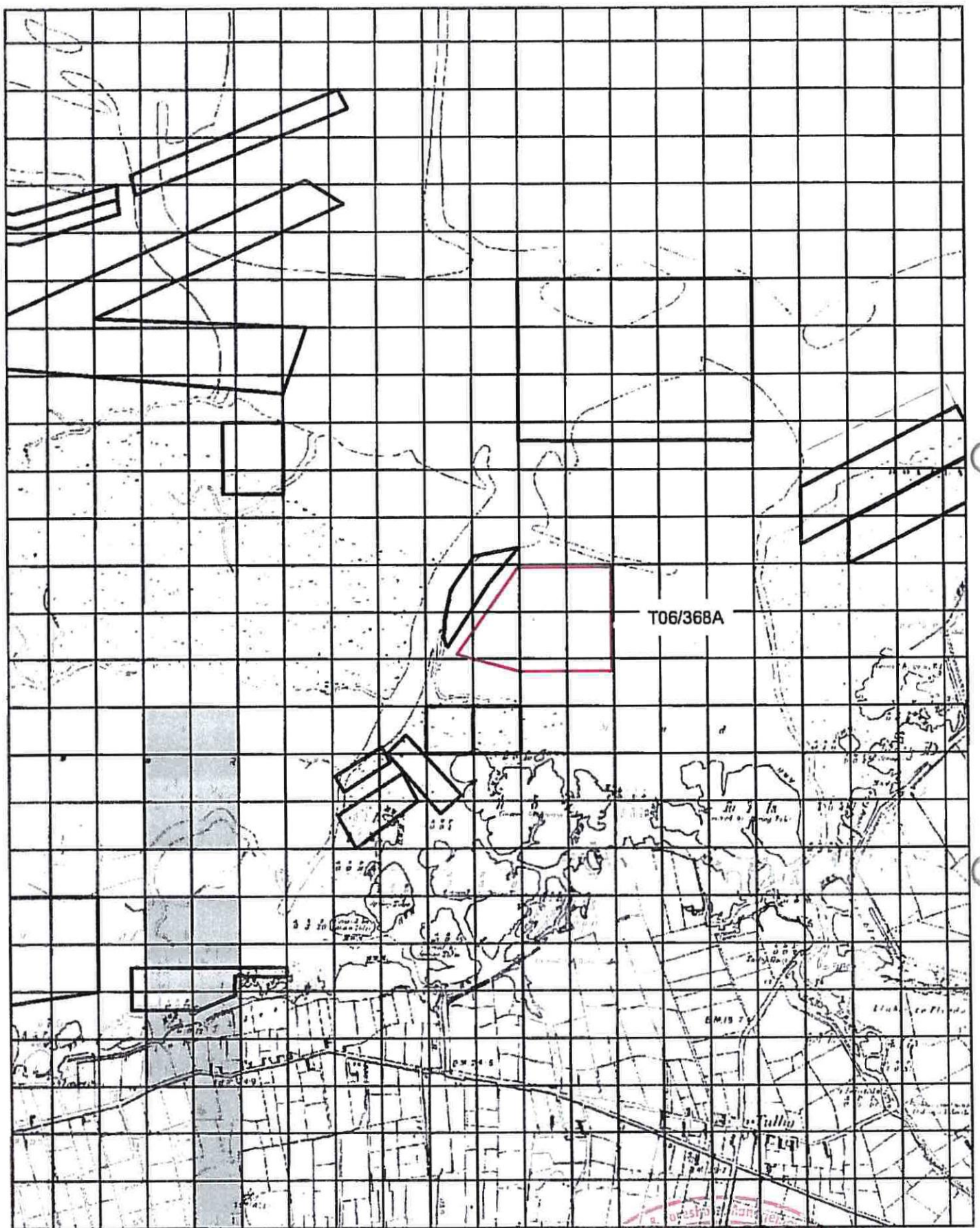

Aqua Culture Sites
 Site Status
 Application:
 Applied
 Not Applied
 Withdrawn
 Revoked
 Suspended
 Withdrawn
 Other

1:10,560

Ordnance Survey Ireland Licence No. EN0076413
 © Ordnance Survey Ireland/Government of Ireland

Sites highlighted in red denotes Application



Department of
**Agriculture,
 Food and the Marine**
 An Póirt
**Talmhaíochta,
 Bia agus Mara**

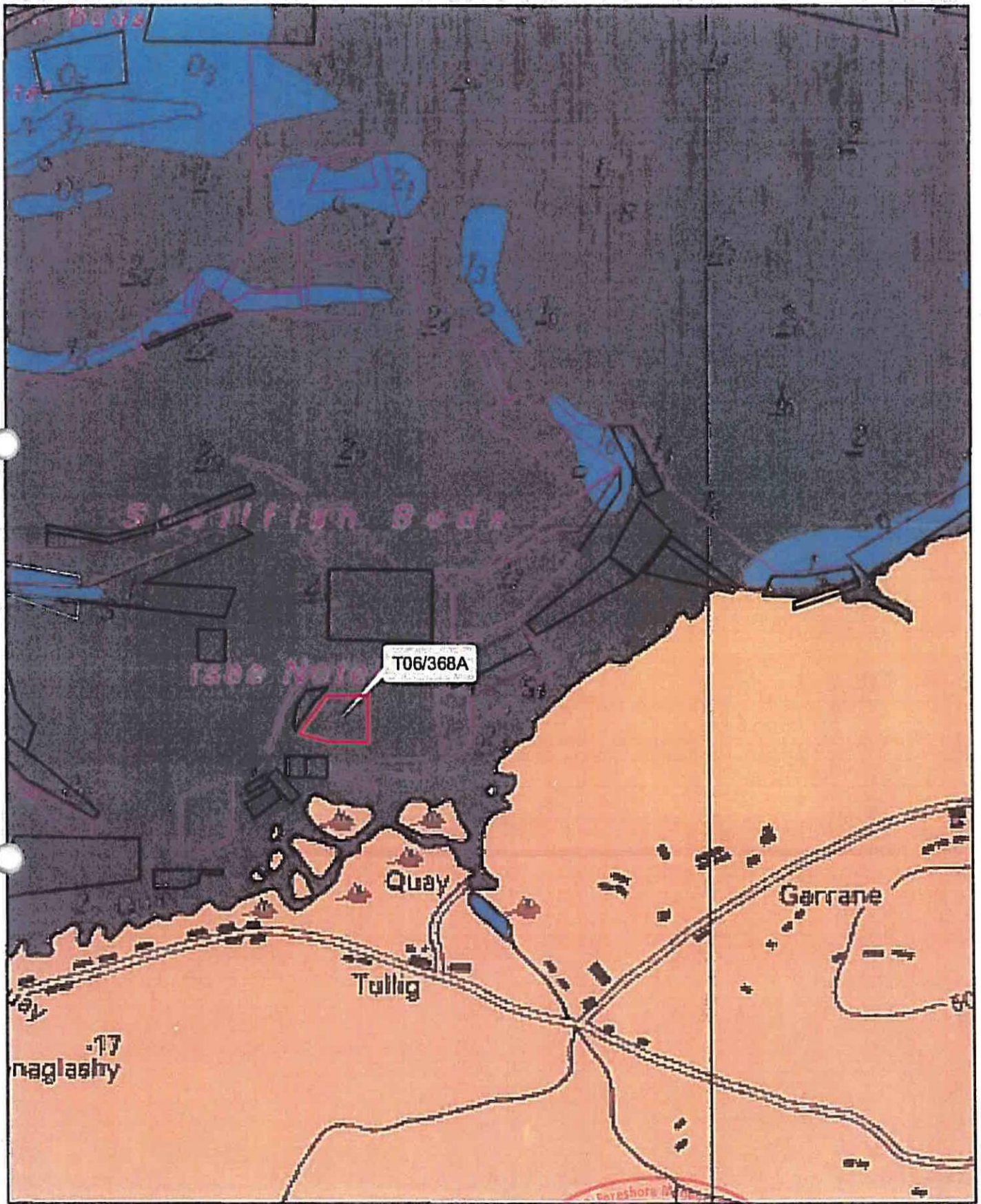

Aqua Culture Sites
(all other values)

Site_Status	Application
[Symbol]	Applied
[Symbol]	Granted
[Symbol]	Refused
[Symbol]	Revoked
[Symbol]	Revoked
[Symbol]	Surrendered

1:24,000

Part of Admiralty Chart No 2789-1

Not to be used for Navigation

Sites highlighted in red denotes Application



Department of
**Agriculture,
Food and the Marine**
A: Beinn
Talmhachta,
Bla agus Mara

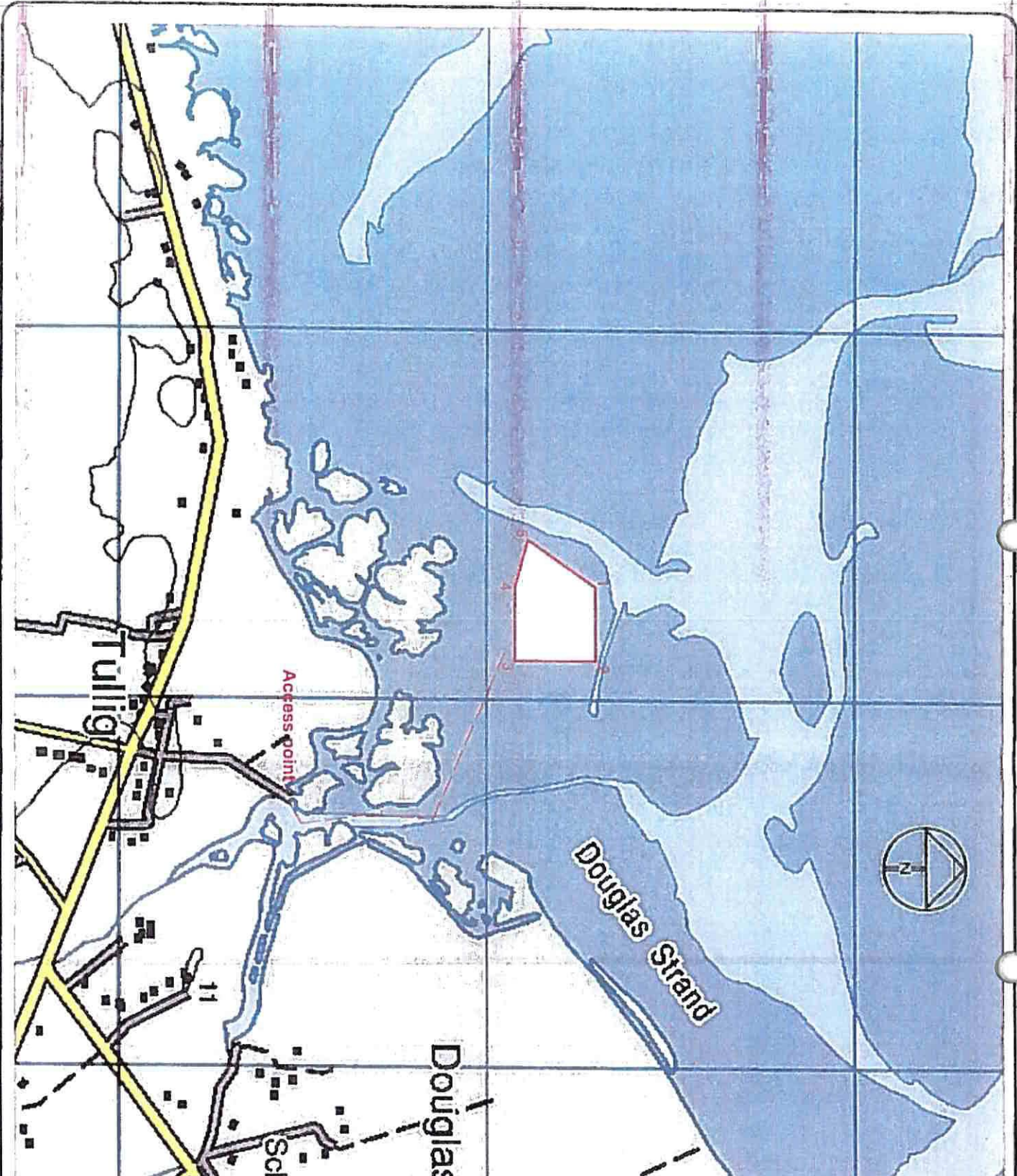

GENERAL NOTES

All dimensions are in millimetres, unless noted otherwise.

Site area = 5.82 hectares

Site coordinates in Irish Grid			
No	Eastings	Northings	
1.	72696	90294	
2.	72896	80294	
3.	72895	90074	
4.	72899	90074	
5.	72597	90110	

T6 - 368A

Rev	Date	Description	HG	DW
A	04/02/2014	Issued for information		

Project
Aquaculture Licence Application
Castlemaine Harbour

Client
Martin Riordan

Drawing Title
Site Location

HELEN GRIFFIN
087 1275600
hgri@eng.ie
Civil & Structural Consulting Engineers
16 Hunters Wood
Tralee
Co. Kerry

Scale 1:10,000

Drawn	HG	04/02/2014
Checked	DW	04/02/2014
Approved	DW	04/02/2014

Fig. No. 0502-1001-A

GENERAL NOTES

All dimensions are in millimetres, unless noted otherwise.

Site area = 5.02 hectares

Rev	Date	Description	By	App
A	24.02.2014	Issued for Information	HG	DW

Project
 Aquaculture Licence Application
 Castlemaine Harbour

Client
 Martin Riordan

Drawing Title
 Site Layout

HELEN GRIFFIN
 087 1275600
 hgriffin@gwe.ie

Civil & Structural Consulting Engineers
 16 Hunters Wood
 Tralee
 Co. Kerry

Scale	Version	Date
Drawn	HG	24.02.2014
Checked	DW	24.02.2014
Approved	HG	24.02.2014

Proj. No.
 0502-1002-A

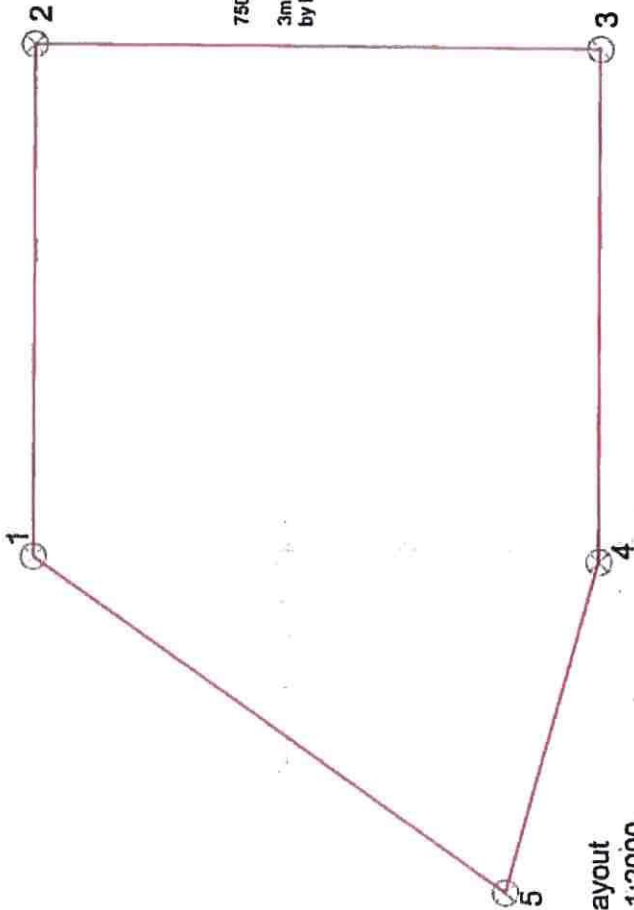

Site Layout
 Scale 1:2000

750mm between each row of trestles
 3m between every fourth row to allow access by boat

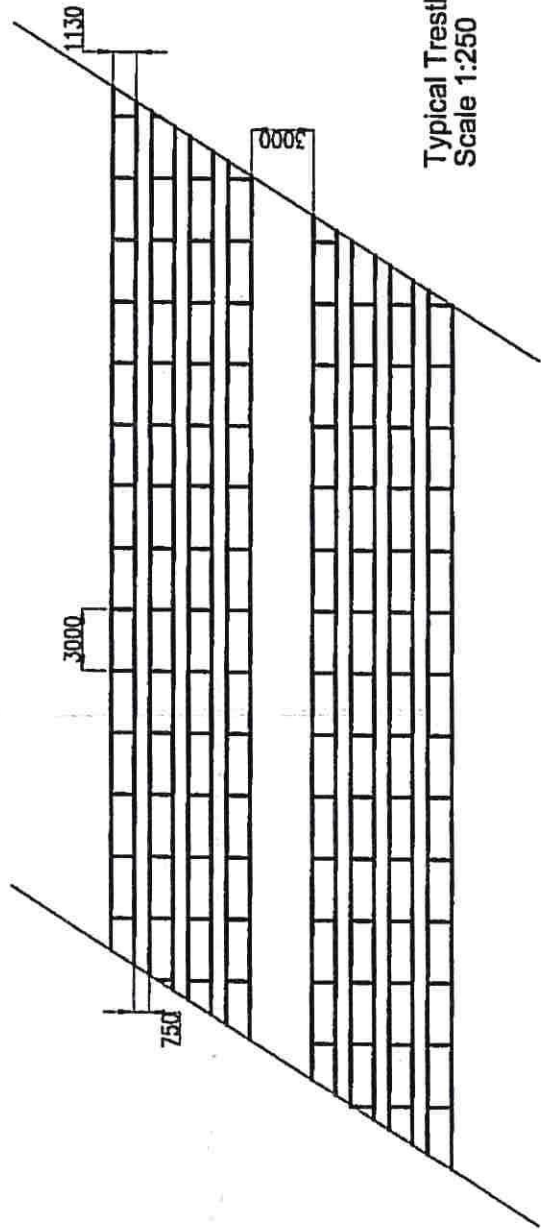

Typical Trestle Layout
 Scale 1:250